

FACILITY OVERVIEW

The Gardens

Cylburn Arboretum: 4915 Greenspring Avenue, Baltimore, MD 21209

Howard P. Rawlings Conservatory: 3100 Swann Drive, Baltimore, MD 21217

VENUE AMENITIES

- Vendor only access for load in/out
- Designated outdoor catering areas
- Limited 20-amp electrical outlets
- Limited aater access
- Garbage cans (50 gallon)
- Recycling bins (30 gallon)
- (1) Garbage and (1) Recycling Dumpster

FURNITURE

Garden ceremony chairs available for rent at Rawlings Conservatory only. All other tents and furniture must be rented from an outside vendor. Deliveries should be made during the client's rental period.

END OF EVENT DUTIES

- Remove all personal and rental items
- Remove garbage/recycling
- Sweep hard surfaces as needed
- Check-in with Event Assistant

FORMAL GARDEN LAYOUTS:

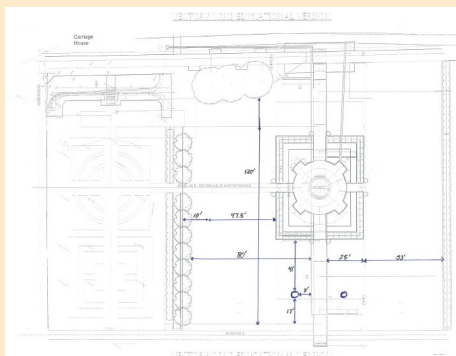

Cylburn Formal Garden



Contact the Rental Team at:
410-396-4860
garden.events@baltimorecity.gov

SPECIAL NOTES:

Garden rentals limited to weddings only.

Tents and furniture rentals required for outdoor receptions.

Limited access to power in the gardens.
Generators recommended.

Driving on turf and blue stone pathways is prohibited.

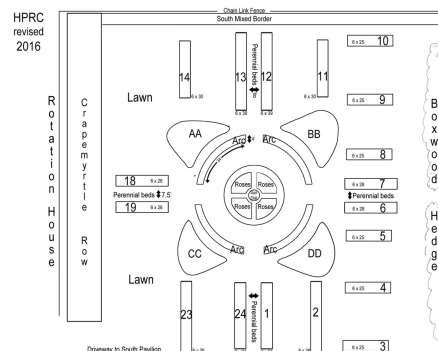

Rawlings Formal Garden

For more information, visit:
<https://bcpr.baltimorecity.gov/about-rec-parks/rentals>